

# shoreline 3

## SHORELINE 3

**3 Bed**  
**2-1/2 Bath • 2 Car Garage**

|                    |                   |
|--------------------|-------------------|
| 1st Floor A/C      | 781 s.f.          |
| 2nd Floor A/C      | 924 s.f.          |
| <b>TOTAL A/C</b>   | <b>1,705 S.F.</b> |
| 2 Car Garage       | 426 s.f.          |
| Covered Entry      | 59 s.f.           |
| Covered Patio      | 130 s.f.          |
| <b>GROSS TOTAL</b> | <b>2,320 S.F.</b> |



mediterranean elevation



contemporary elevation



coastal elevation

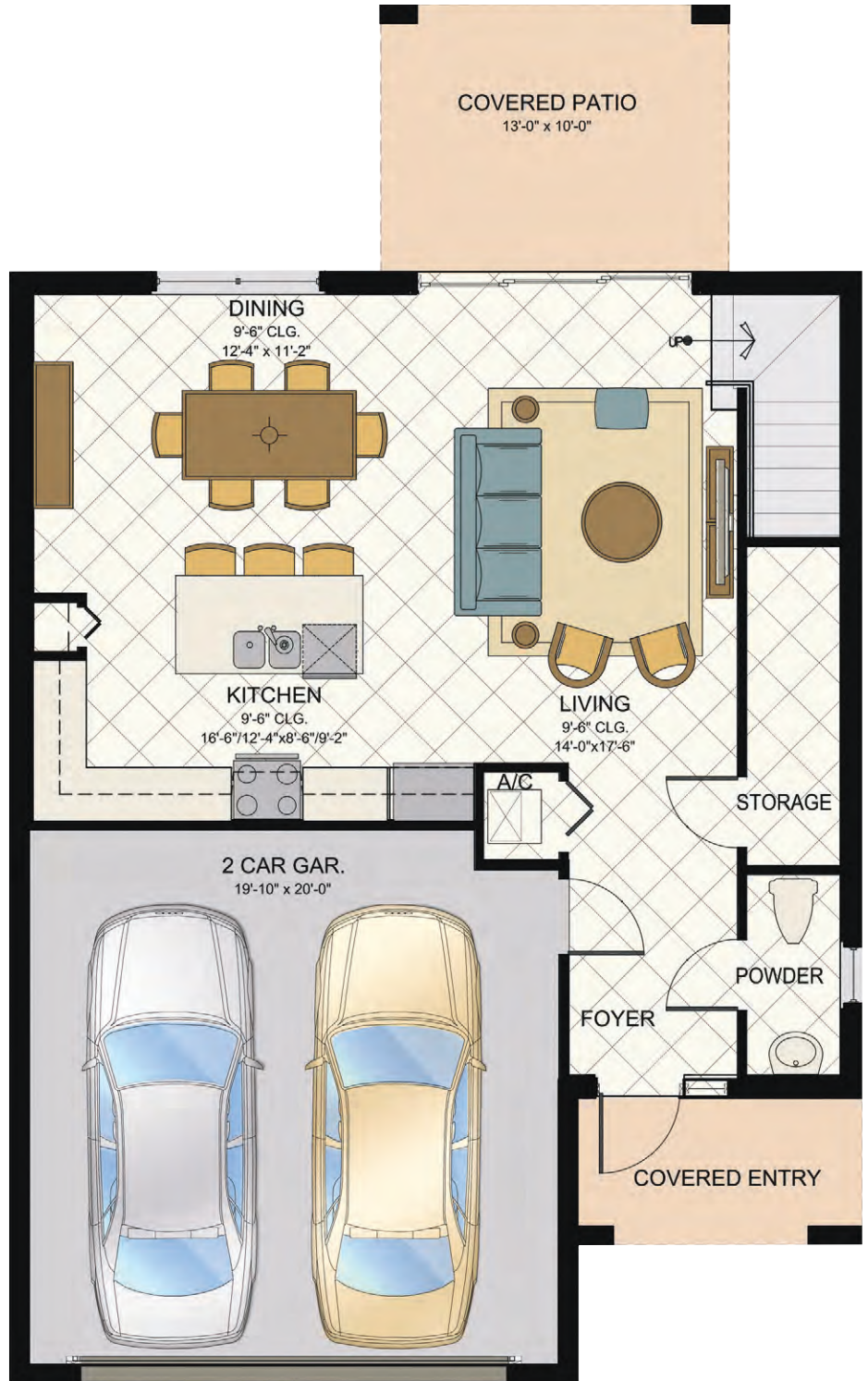

1ST FLOOR PLAN



# shoreline 3

(continued)



2ND FLOOR PLAN

