

SEQUOIA

Starting from \$672,490
Est. Mortgage \$4,019/month

(407) 708-3541





OVERVIEW

 Apopka, FL

 4 - 5 Bedrooms

 3,417–3,430 Sq. Ft.

 From \$590s

 3.5 - 4 Bathrooms

The Sequoia Plan is a two-story, single-family home offering a formal dining room perfect for special occasions and a 3-car garage.

FLOORPLAN

1st Floor

Base Floorplan



FIRST FLOOR
Floor Plan Depicts the Mediterranean L Exterior

Room Choices Floorplan

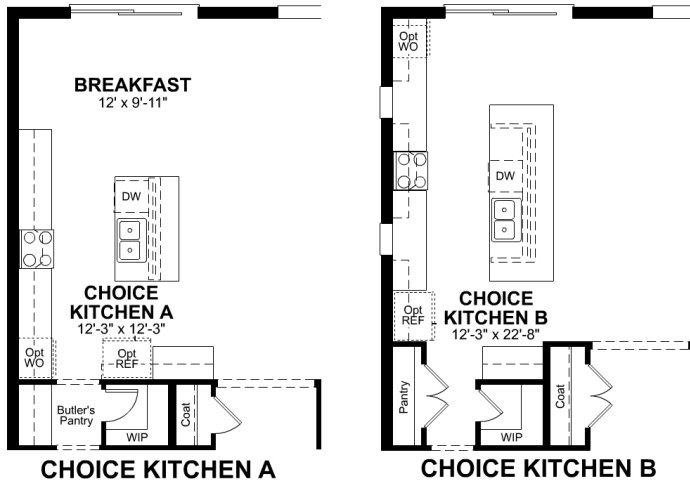

Paid Options Floorplan

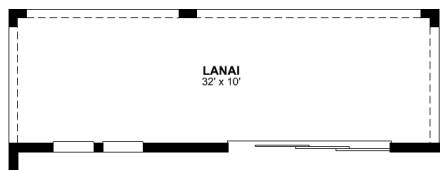

**OPTIONAL 12' SLIDING GLASS DOOR
& OPTIONAL EXTENDED LANAI**



**OPTIONAL GUEST SUITE
ILO STUDY**

2nd Floor

Base Floorplan



SECOND FLOOR
Floor Plan Depicts the Mediterranean L Exterior

Room Choices Floorplan

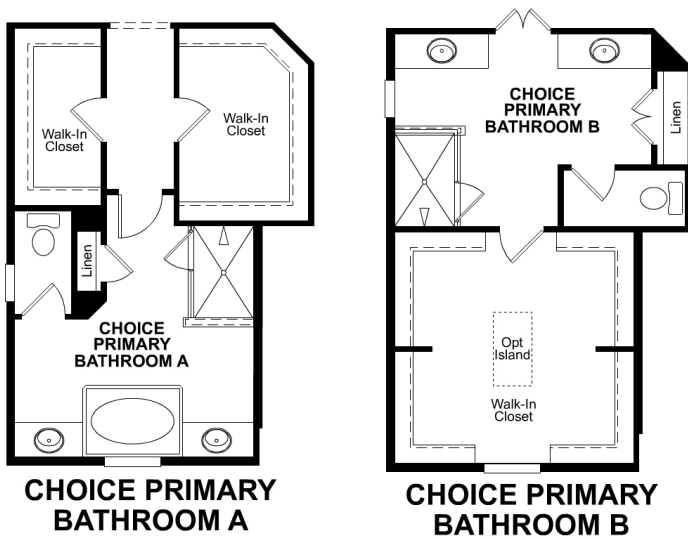

DETAILS AND FEATURES

- Foyer gives this plan an open and spacious feel from the moment you enter
- Create lasting memories in your new great room - perfect for game nights, movie nights and entertaining
- Secondary bedrooms all boast walk-in closets for optimal hanging and storage space
- Fit an ironing board and optional cabinets or countertops in the oversized laundry room



MONTHLY MORTGAGE

Your Estimated Payment is
\$4,019

Taxes and insurance not included in monthly mortgage payment.

Home Price:

672,490

Down Payment:

67,249

10

Loan Program:

30 year term



Interest Rate:*

6.98

Beazer reserves the right to make changes without notice or obligation to plans, exteriors and pricing. Illustrations and specifications are believed correct at time of publication, and are not intended to create any warranty or contract rights. All dimensions are approximate. Details shown may vary depending on the elevation and options chosen. All plans are the property of Beazer Homes. Consult your New Home Counselor for complete details ©2017 Beazer Homes.

The home pictured is intended to illustrate a representative home in the community, but may not depict the lowest advertised priced home. The advertised price may not include lot premiums, upgrades and/or options. All home options are subject to availability and site conditions. Beazer reserves the right to change plans, specifications, and pricing without notice in its sole discretion. Square footages are approximate. Exterior elevation finishes are subject to change without prior notice and may vary by plan and/or community. Interior design, features, decorator items, and landscape are not included. All renderings, color schemes, floor plans, maps, and displays are artists' conceptions and are not intended to be an actual depiction of the home or its surroundings. A home's purchase agreement will contain additional information, features, disclosures, and disclaimers. Please see New Home Counselor for individual home pricing and complete details. No Security Provided: If gate(s) and gatehouse(s) are located in the Community, they are not designed or intended to serve as a security system. Seller makes no representation, express or implied, concerning the operation, use, hours, method of operation, maintenance or any other decisions concerning the gate(s) and gatehouse(s) or the safety and security of the Home and the Community in which it is located. Buyer acknowledges that any access gate(s) may be left open for extended periods of time for the convenience of Seller and Seller's subcontractors during construction of the Home and other homes in the Community. Buyer is aware that gates may not be routinely left in a closed position until such time as most construction within the Community has been completed. Buyer acknowledges that crime exists in every neighborhood and that Seller and Seller's agents have made no representations regarding crime or security, that Seller is not a provider of security and that if Buyer is concerned about crime or security, Buyer should consult a security expert. Beazer Homes is not acting as a mortgage broker or lender. Buyers should consult with a mortgage broker or lender of their choice regarding mortgage loans and mortgage loan qualification. There is no affiliation or association between Beazer Homes and a Choice Lender. Each entity is independent and responsible for its own products, services, and incentives. Home loans are subject to underwriting guidelines which are subject to change without notice and which limit third-party contributions and may not be available on all loan products. Program and loan amount limitations apply. Not all buyers may qualify. Any lender may be used, but failure to satisfy the Choice Contribution requirements and use a Choice Lender may forfeit certain offers. The utility cost shown is based on a particular home plan within each community as designed (not as built), using RESNET-approved software, RESNET-determined inputs and certain assumed conditions. The actual as-built utility cost on any individual Beazer home will be calculated by a RESNET-certified independent energy evaluator based on an on-site inspection and may vary from the as-designed rating shown on the advertisement depending on factors such as changes made to the applicable home plan, different appliances or features, and variation in the location and/or manner in which the home is built. Beazer does not warrant or guarantee any particular level of energy use costs or savings will be achieved. Actual energy utility costs will depend on numerous factors, including but not limited to personal utility usage, rates, fees and charges of local energy providers, individual home features, household size, and local climate conditions. The estimated utility cost shown is generated from RESNET-approved software using assumptions about annual energy use solely from the standard systems, appliances and features included with the relevant home plan, as well as average local energy utility rates available at the time the estimate is calculated. Where gas utilities are not available, energy utility costs in those areas will reflect only electrical utilities. Because numerous factors and inputs may affect monthly energy bill costs, buyers should not rely solely or substantially on the estimated monthly energy bill costs shown on this advertisement in making a decision to purchase any Beazer home. Beazer has no affiliation with RESNET or any other provider mentioned above, all of whom are third parties.

ACUERA ESTATES

From \$590s

(407) 708-3541

Single Family Homes

3017 Water Clover Court

Apopka, FL 32712

Mon - Tues, Thurs - Sat: 10am - 6pm

Wed, Sun: 12pm - 6pm



OVERVIEW

 Apopka, FL

 4 - 5 Bedrooms

 2,687 - 3,430 Sq. Ft.

 From \$590s

 3 - 4 Bathrooms

Acuera Estates is a new single-family home community offering private, oversized homesites with 3-car garages in Apopka, FL. Live in this prime location close to SR 429, recreation, and shopping.

CONTACT INFORMATION

Acuera Estates
3017 Water Clover Court
Apopka, FL 32712
(407) 708-3541

Mon - Tues, Thurs - Sat: 10am - 6pm
Wed, Sun: 12pm - 6pm

MAP

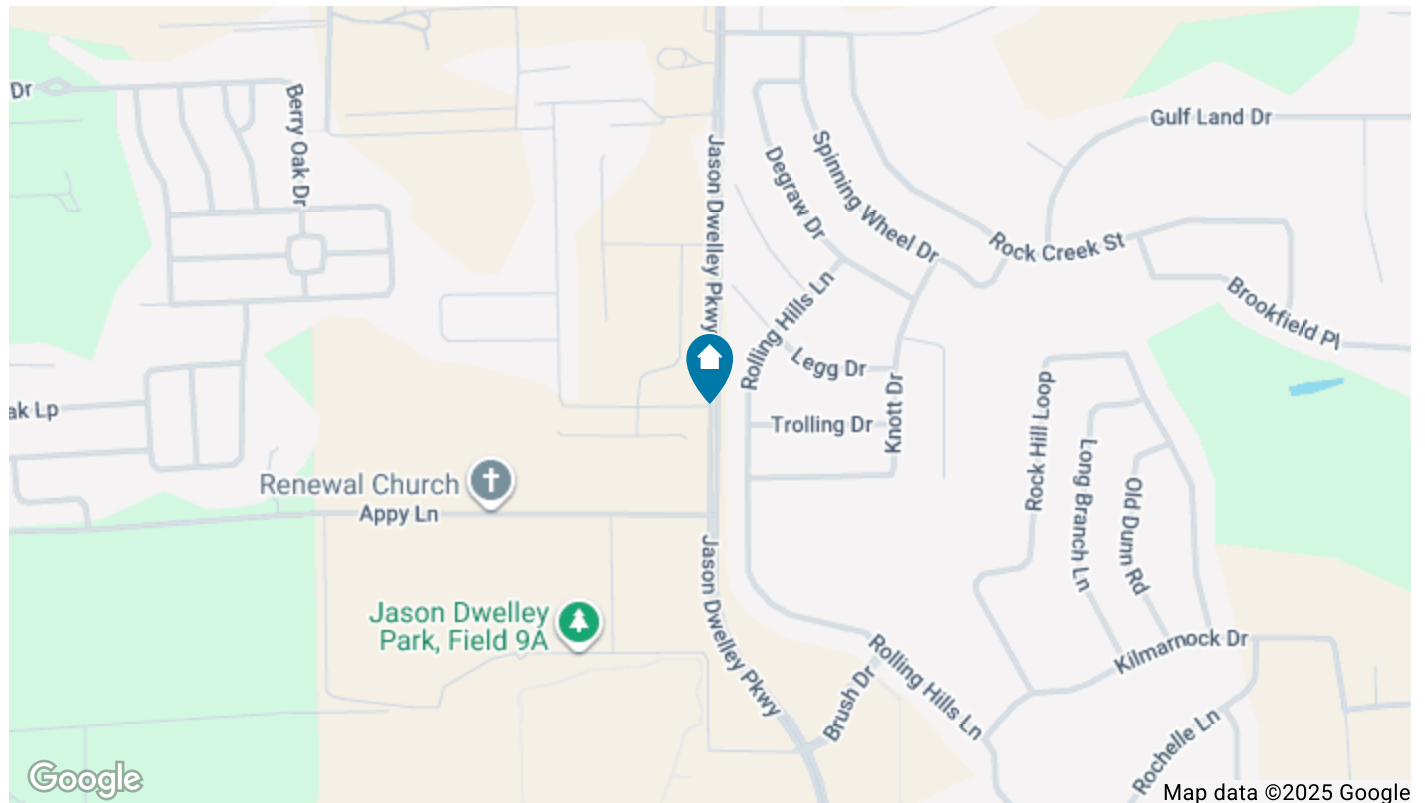

From I-4 West

1. Take exit 101 B-A for State Hwy 417/FL-46
2. Keep right at the fork and merge onto FL-429 S
3. Take exit 38 for Kelly Park Road
4. Turn left on to W Kelly Park Road
5. Turn right onto Jason Dwelley Parkway
6. Community will be ahead on the right

From SR 429 North

1. Take exit 38 for Kelly Park Road
2. Turn right on to W Kelly Park Road
3. Turn right onto Jason Dwelley Parkway
4. Community will be ahead on the right

From 441 South

1. Turn left onto Sadler Road
2. Turn left onto Round Lake Road
3. Turn right onto W Kelly Park Road
4. Turn right onto Jason Dwelley Parkway
5. Community will be ahead on the right